



MSJ series MSJ-300



Valve Regulated Lead Acid Battery

Maintenance-Free Sealed Lead Acid Battery.
Absorbent Glass Mat (AGM) technology for efficient gas recombination of up to 99%.

General Design for Standby Power Applications

【Design Life】

Up to 20 Years in Standby Service at 25°C
Eurobat (20°C) : >12 YEARS VERY LONG LIFE

【Operating Temperature Range】

Nominal Operating Temperature : 25°C (77°F)
Discharge : -15°C ~ 50°C (5°F~122°F)
Charge: -15°C ~ 40°C (5°F~104°F)
Storage: -15°C ~ 40°C (5°F~104°F)

【Float Charging Voltage】

2.21 ~ 2.25 VDC/Unit at 25°C (77°F)

【Equalization Charging Voltage】

2.35 VDC/Unit at 25°C (77°F)

【Self Discharge】

Less than 10% after 90 days, can be stored up to 6 months at 25°C (77°F);
Fully recharging is required before usage, and charged sooner if stored at higher temperature than 25°C (77°F).

Specification

Nominal Voltage	2V (single cell per unit)		
Nominal Capacity	300 Ah @10hr-rate to 1.80V per cell @25°C (77°F)		
Weight	Approx. 21.80 Kg (48.05 lbs)		
Maximum Discharge Current	1800 A (5sec)		
Internal Resistance	Approx. 0.33 mΩ		
Short Circuit Current	5075A		
Maximum Charge Current	90 A		
Terminal types	I4 thread copper alloy terminal to accept M8 bolt		
Terminal tightening torque	126±25 Kgf·cm / 109±22 Lbf·in / 12.3±2.5 N·m		
Container Material	Flame Retardant ABS (UL 94-V0)		
Dimensions	Depth (D)	170.0±2.0 mm	6.69±0.08 inch
	Width (W)	150.0±1.5 mm	5.91±0.06 inch
	Container height (h)	331.0±2.5 mm	13.03±0.10 inch
	Overall Height (H)	339.0±2.5 mm	13.15±0.10 inch

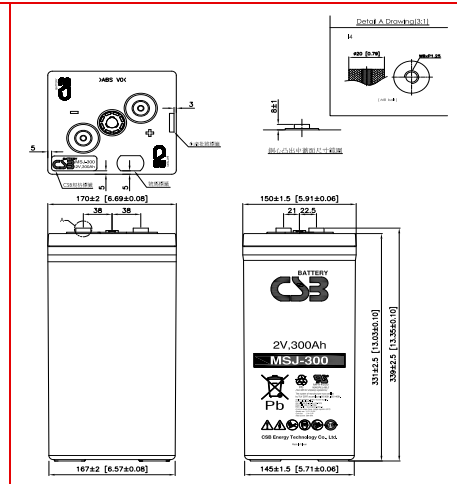

Constant Current Discharge Characteristics Unit: A (25°C, 77°F)

F.V/Time	15MIN	30MIN	60MIN	2HR	2.5HR	3HR	5HR	6HR	8HR	10HR	20HR	24HR
1.60V	556	372	228	131	109	93.6	59.0	50.0	39.1	32.3	16.2	13.5
1.67V	498	354	222	129	107	92.6	58.4	49.5	38.7	32.1	16.0	13.4
1.70V	468	342	218	128	107	92.0	58.1	49.2	38.5	31.9	16.0	13.3
1.75V	421	311	207	125	105	90.3	57.1	48.4	38.0	31.5	15.7	13.1
1.80V	360	276	191	120	100	87.1	55.3	47.1	37.0	30.7	15.3	12.8
1.83V	318	253	179	114	96.3	83.7	53.5	45.7	35.9	29.8	14.9	12.4

Constant Power Discharge Characteristics Unit: W (25°C, 77°F)

F.V/Time	15MIN	30MIN	60MIN	2HR	2.5HR	3HR	5HR	6HR	8HR	10HR	20HR	24HR
1.60V	974	675	414	249	207	179	117	100	76.9	60.2	30.1	25.1
1.67V	905	649	406	247	206	177	116	99.7	76.3	59.7	29.9	24.9
1.70V	869	633	400	245	204	176	116	99.3	75.9	59.5	29.7	24.8
1.75V	794	591	384	240	201	173	114	98.1	74.8	58.6	29.3	24.4
1.80V	712	534	358	231	194	168	112	95.7	72.5	57.0	28.5	23.7
1.83V	642	498	338	221	187	162	108	93.3	70.3	55.2	27.6	23.0

Please refer to the official site for the latest rating confirmation. URL: www.csb-battery.com

Issued: 201112

Sales Offices

希世比能源科技股份有限公司
CSB Energy Technology Co., Ltd.

BUSINESS HEADQUARTERS

Tel: +886-2-2880-5600
Fax: +886-2-2888-3300

USA OFFICE

Tel: +1-817-244-7777 / 1-(800)3-CSB-USA (272872)
Fax: +1-817-244-4445

SHENZHEN OFFICE (CHINA)

Tel: +86-755-8831-6488/6775/6075
Fax: +86-755-8831-6548

EUROPE (EMEA) OFFICE

Tel: +31(0)180-418-140
Fax: +31(0)180-418-327

SHANGHAI OFFICE (CHINA)

Tel: +86-21-5046-1622/0833/0094
Fax: +86-21-5046-1046

Recognized under UL 1989,
and certified by ISO 9001, 14001, 45001, 50001.



TAIPEI OFFICE

Tel: +886-2-2880-5600
Fax: +886-2-2888-3300

BEIJING OFFICE (CHINA)

Tel: +86-10-6597-8065/8165/8265
Fax: +86-10-6597-8565